

INSTALLATION GUIDE INTERNAL HEAD RESTRAINTS



IHR Internal Head Restraints

The Ancon IHR is designed to restrain the top of internal walls or the top of the inner leaf of a cavity wall. It comprises an L-shaped channel stem and a top section available in a variety of designs to suit different fixing methods and substrates; the top section slides in the channel to accommodate vertical movement between the blockwork and the structure.

Channel Stem

The channel stem is closed at the front to prevent mortar ingress.

The standard height of an IHR will suit a 215mm block. Other stem lengths are also available to suit cut blocks with a minimum height of 150mm.



Sliding Top Section

The IHR sliding top section is available in two standard lengths; one length to accommodate a gap of up to 50mm, and another to accommodate gaps of 51-75mm.

Positioning

The horizontal leg of the lower section, should be placed directly on top of the block below. The vertical joint should be filled with mortar each side of the stem. IHR's should ideally be positioned centrally in the width of the wall, where this is not possible the centre of the stem should be at least 50mm from the edge of the wall.

IHR Head Restraints will typically be positioned at 450mm or 900mm centres depending on the expected load at the top of the wall. The table provides the design resistance per metre for the IHR range when installed with a 25mm, 50mm and 75mm gap.

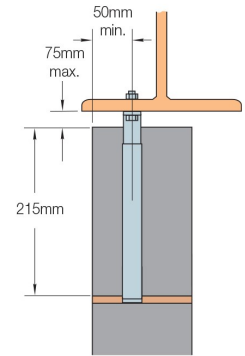
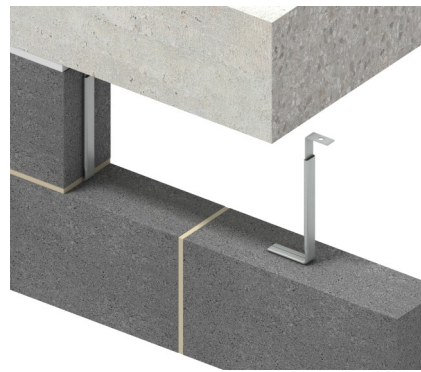

Ancon IHR-B with 9mm dia. hole

Ancon IHR-V with 9mm x 25mm slot

Ancon IHR-S with 6mm dia. hole

Ancon IHR-C to suit cast-in channel

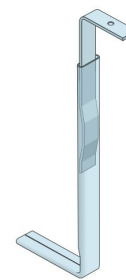
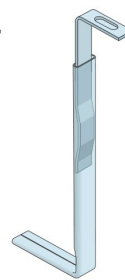
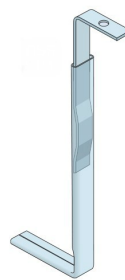

IHR - C 38 to suit 38/17
IHR - C 30 to suit 30/20

Fixings

The sliding tie is provided with either a hole (IHR - B) or slot (IHR - V) to suit M8 bolts, a hole (IHR-S) to suit a SDTSS-38-5PT self-tapping screw or a notch end (IHR-C) to fix directly into a 38/17 or 30/20 cast-in channel.

Where IHR-B or IHR-V are used, the head of the fixing bolt will reduce the amount of possible vertical movement. Bolt projections should be kept to a minimum, the top of the block may need to be cut back locally to accommodate the fixing head.

Before Installation

Check that the IHR ordered and supplied meets the dimensions and performance specifications of your application.

Product Reference	Spacing	Design Resistance (per metre)		
		25mm Gap	50mm Gap	75mm Gap
IHR-B, IHR-V, IHR-C and IHR-S	900mm	1.78kN/m	1.22kN/m	1.06kN/m
	450mm	3.56kN/m	2.44kN/m	2.11kN/m

Safety Precautions

Suitable personal protective equipment should be worn at all times during handling and installation of fabricated stainless steel building products.

© Ancon Ltd, 2019

The Construction applications and details provided in this guide are indicative only.

In every case installation should be entrusted to appropriately qualified and experienced persons.

Normal handling precautions should be taken to avoid physical injury. Ancon cannot be held responsible for any injury as a result of using our products, unless such injury arises as a result of our negligence.



Tel: 3 376 5205

Email: info@ancon.co.nz

Web: www.ancon.co.nz